

How to Test Operation and Setup

"Babysense V" is an extremely sensitive device which monitors baby's every movement through the mattress during sleep. There are two main causes of malfunction – technical malfunctions and malfunctions due to environmental causes:

Technical malfunction: In order to minimize technical problems, follow installation and operation instructions carefully.

Environmentally caused malfunction: Due to the extreme sensitivity of "Babysense V", it may be influenced by vibrations caused by fans, wind, a/c and so forth. Vibrating household sources (washing machine, loud music, train) may be picked up by the movement sensor on a similar level to that of slight movements, thus preventing or delaying alarm activation.

Therefore the following Performance Test must be conducted at least once daily and every time Babysense is set up in a different location.

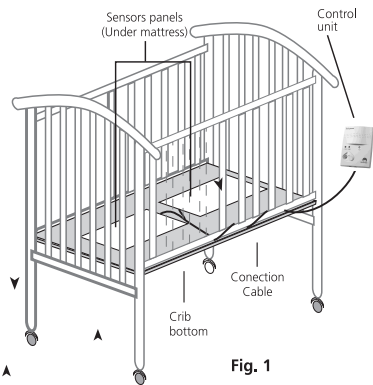

IMPORTANT: To avoid possible danger from dangling sensor cords, collect excess cord length with the included tie.

Performance Test:

- Check that when baby is in the bed, the green light flashes.
- Remove baby from bed and **turn off device**. AFTER TURNING OFF, WAIT 3 minutes while the mattress shifts due to removal of the baby's weight.
- TURN DEVICE ON again without moving the bed (without baby in bed).
- Watch for green light – blinking will indicate that surrounding interferences are being read as false movement recordings. This must be corrected (see below).
- Make sure that alarm sounds within 20 seconds (due to absence of movement). The alarm may sound in less than 20 seconds, and can be with or without preliminary ticking.
- Check that alarm can be heard in all likely locations for listener.

Locating and dealing with surrounding interferences:

If the alarm does not sound after 20 seconds, and/or green light flashes when baby is not in bed, eliminate all surrounding interferences by such actions as changing ventilation, removing mobiles, closing windows, repositioning bed and the like.

False alarms:

Isolated cases of false alarms are possible. Check if caused by faulty connection of the sensor pad(s) to the control unit, connection of only one pad when baby can move off the pad area, or failure of the sensor pads to be directly against the mattress. (see Trouble Shooting chart).

Caution:

"Babysense" monitors and alerts, but cannot prevent any type of distress. **The responsibility for assistance rests on you.** "Babysense V" senses movements and motion only, and cannot monitor other occurrences.

The purpose of the device is to alert you when stopping or slowing of movement occur.

Installation

1. Place the two sensor pads (see fig. 1), or one sensor pad (see following note on newborns) on the solid flat base of the bed. Place mattress firmly on top of sensor pad/s. If the bed base is soft, padded or contains springs, simply place a solid board on the bed base, place the sensor pads on the board and place the mattress firmly on top.
2. Remove battery cover (see fig. 3), remove battery housing and insert, in accordance with the markings, 4 new size AA 1.5 volt batteries, preferably alkaline. Replace battery housing and close cover.
3. Attach the cords of the two sensor pads to the double-socket of the connecting cable. Attach end of connecting cable to the outlet marked "SENSOR-IN" on the control unit. When using a single sensor pad, attach cord directly to the "SENSOR-IN" outlet without using the connecting cable.
4. Press hanging bracket firmly into slot in back of control unit (see fig. 3), and hang from the bottom of the bed, or anywhere out of baby's reach.

Operation

To operate, press on/off button. When switched on, the control lights switch on briefly and a click is heard. When movement is detected, the green light flashes. If (4) red low-battery warning light flashes (see fig. 2), replace batteries as soon as possible. If in addition clicking is heard, batteries must be replaced immediately. Turn off by pressing on/off button.

See fig. 2 for layout of control unit featuring:

1. On/off button under protective cover.
2. Motion-activated green light.
3. Red alarm light, activated if baby's movement stops or slows significantly.
4. Low battery warning light.

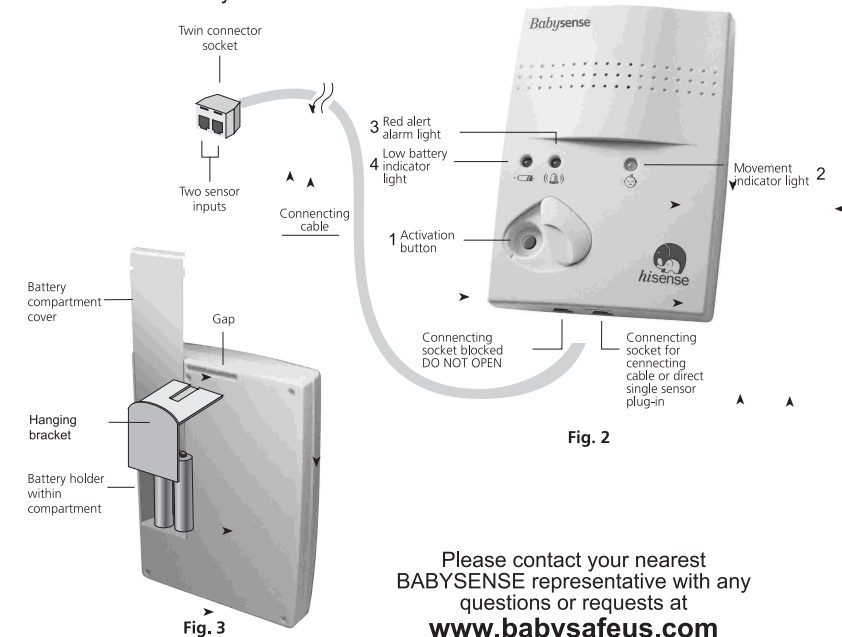

Please contact your nearest BABYSENSE representative with any questions or requests at www.babysafeus.com